



INSTALLATION INSTRUCTIONS

512-0109-B

CHEVROLET SILVERADO 1500 / GMC SIERRA 1500

2019 - 2024

ENGINE: L3B 2.7L TURBO

FILTER: CF-7540

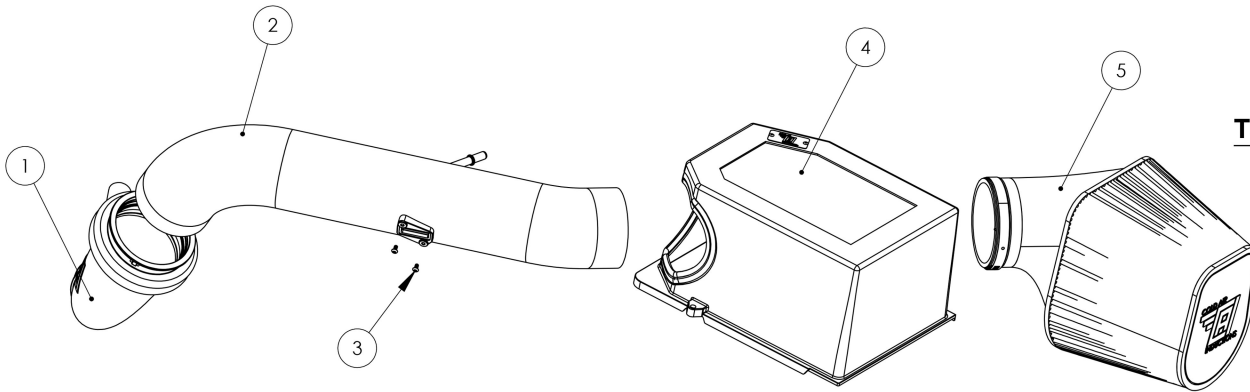

TOOLS NEEDED:

- Ratchet
- Extension
- 10mm socket
- 8mm socket
- 8mm Nut driver
- 7mm nut driver
- T20 Torx bit
- 2.5mm Allen wrench

ITEM NO.	PART NUMBER	DESCRIPTION	QTY.
1	ITR-0006-ASM	INLET/TUBE	1
2	ITA-0033-70B	MAF/TUBE	1
3	FTN-0001-BCM	M4-0.7 x 8mm S.S. BUTTON HEAD CAP SCREW	2
4	BOX-0028-70B	AIR INDUCTION HOUSING	1
5	CF-7540	FILTER ELEMENT-A/CL	1

If you need any assistance, **PLEASE VISIT OUR WEBSITE WWW.COLDAIRINDUCTIONS.COM TO VIEW THE INSTALL VIDEO** or call 1-810-392-9999 to speak with a customer service representative.

NOTE: FAILURE TO FOLLOW INSTALLATION INSTRUCTIONS AND NOT USING THE PROVIDED HARDWARE MAY DAMAGE THE AIR INDUCTION SYSTEM, THROTTLE BODY AND ENGINE.

REMOVAL OF OEM SYSTEM



1. Turn off the ignition. Let the engine cool before installation.

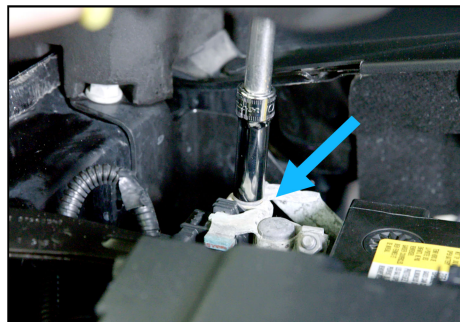

2. Disconnect the negative battery cable with the 10mm socket and ratchet.



3. Unplug MAF sensor.

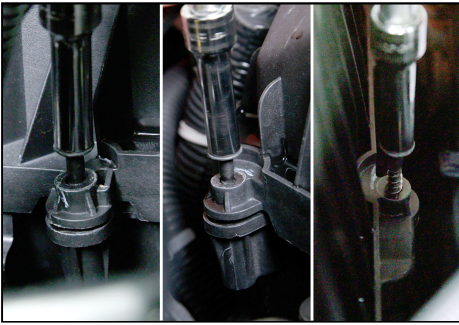

4. Using the 8mm nut driver remove the 3 screws from production air induction housing cover.

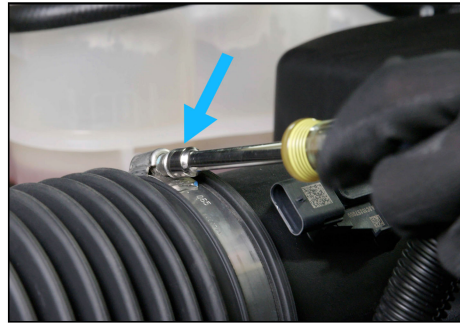

5. Using the 7mm nut driver loosen hose clamp near MAF sensor.



6. Disconnect outlet duct from induction cover.



7. Remove the air induction housing cover and filter.



8. Remove (PCV) Fresh Air tube from Air Cleaner Outlet Duct.



9. Using the 10mm socket remove the 2 bolts on engine cover. Then Remove engine cover.

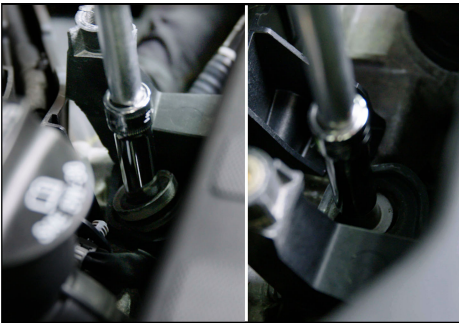

10. Using the 10mm socket remove the 2 nuts holding the Air Cleaner Outlet Duct.



11. Remove the 4 wiring harness ties from Air Cleaner Outlet Duct.

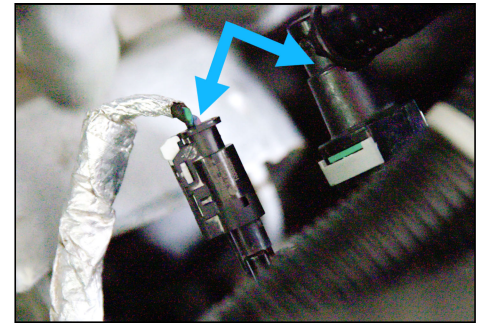

12. Disconnect both cables from Vapor Canister Purge Solenoid Valve.

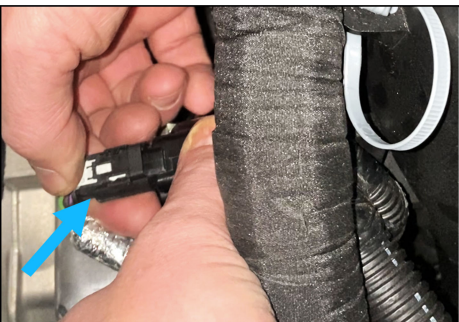

13. To remove the Vapor Canister Purge Solenoid Valve connector, push the white locking clip back until it stops. While compressing the white locking clip between fingers pull connector away from solenoid. Note:(Solenoid clip can be hard to remove).



14. Using 7mm nut driver loosen hose clamp on Air Cleaner Outlet Duct near turbo inlet.

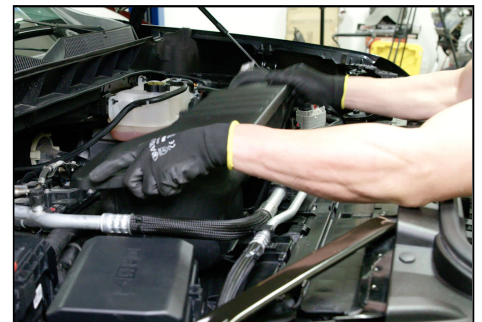

15. Remove the Air Cleaner Outlet Duct.

INSTALLATION OF NEW CAI SYSTEM

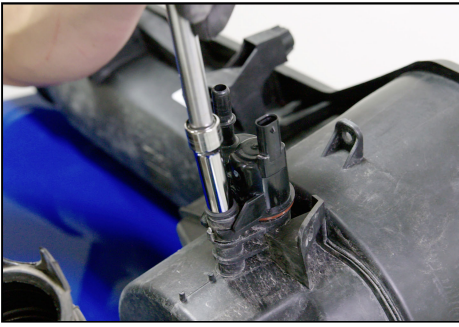

16. Place the Air Cleaner Outlet Duct on the workbench. Using a 10mm socket, remove Vapor Canister Purge Solenoid Valve from the Air Cleaner Outlet Duct.

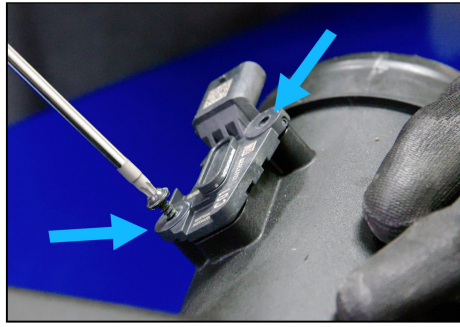

17. Remove the MAF sensor using a T20 Torx. By removing the 2 screws holding it in place on the MAF/TUBE. NOTE: (Carefully handle the MAF sensor to prevent damage).



18. Peel protective film from logo and glass.

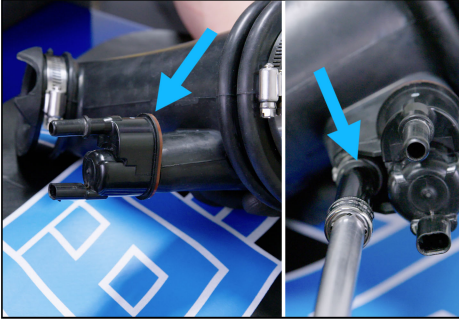

19. Using the 10mm socket, install the Vapor Canister Purge Solenoid Valve on the new air inlet duct using the production bolt.

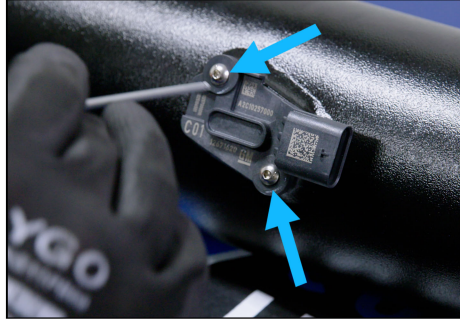

20. Install MAF sensor into the new MAF/TUBE and use a 2.5 mm allen wrench with the new MAF Button head screws provided. Torque both screws to 35 lbf-in (3.9nm).



21. Using the production nuts, install the cover mount brackets provided. Making sure bracket P goes to passenger side and Bracket D goes to the driver's side.

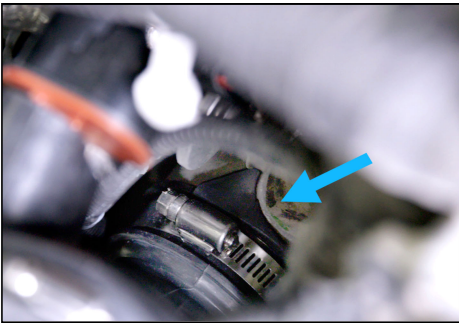

22. Install new air INLET/DUCT onto turbo inlet duct, make sure the notch aligns with the turbo inlet duct as shown. Tighten hose clamp using the 8mm nut driver to 53 lbf-in (6nm).

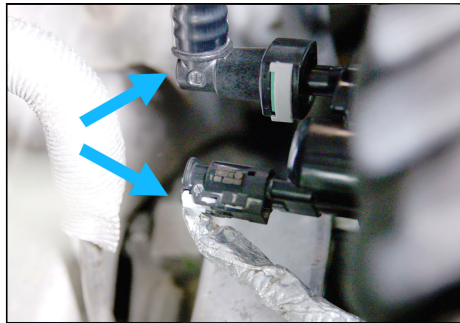

23. Reconnect both cables to the Vapor Canister Purge Solenoid Valve. Remember to press in white tab.



24. Remove hose clamp from the high-performance FILTER ELEMENT to allow the filter to easily fit into the air induction housing. Install filter element into the air induction housing with curved side of the filter toward open end of housing. Re-Install hose clamp onto the end of the filter in the channel provided.

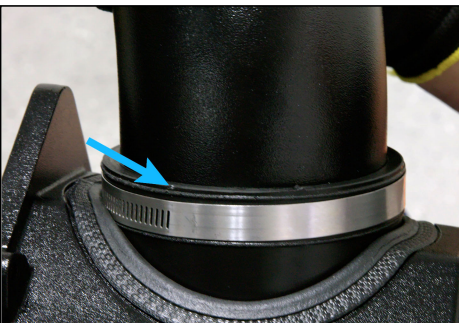

25. Install new MAF/TUBE into filter element making sure to align the small dots located on the MAF/TUBE to the raised locator mark on the lip of FILTER ELEMENT.

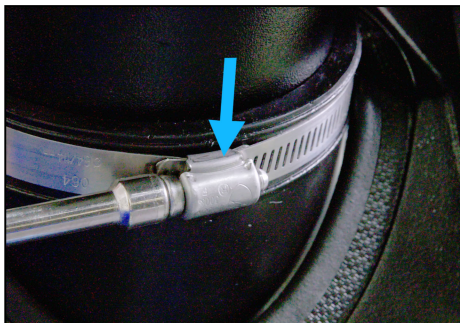

26. Using the 8mm nut driver tighten the hose clamp on filter to 53 lbf-in (6nm).



27. Install Air Induction Assembly onto the existing air induction lower housing and air INLET/Duct near turbo inlet.

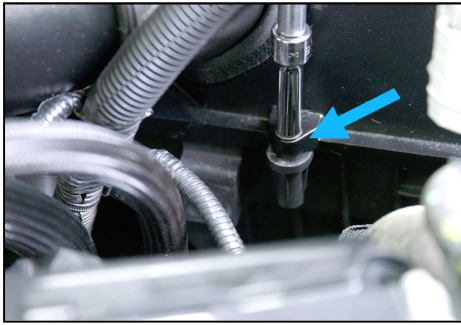

28. Using the 8mm socket install the 3 screws on the Air Induction Housing onto the Air Induction Lower Housing and tighten.

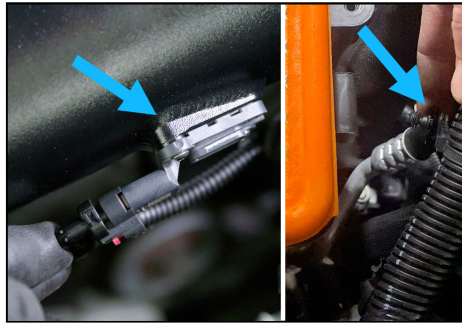

29. Reconnect wiring harness to MAF sensor. (IF MAF wiring harness is too tight. The wiring harness may need to be disconnected from wiring harness supports for extra room).

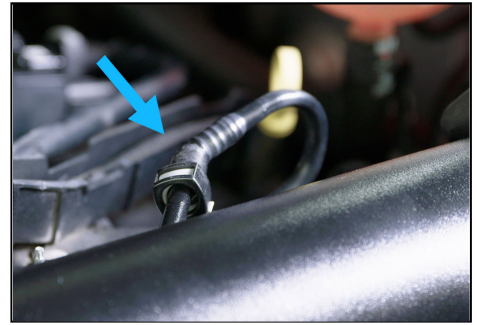

30. Install PCV Fresh Air tube onto MAF/TUBE.

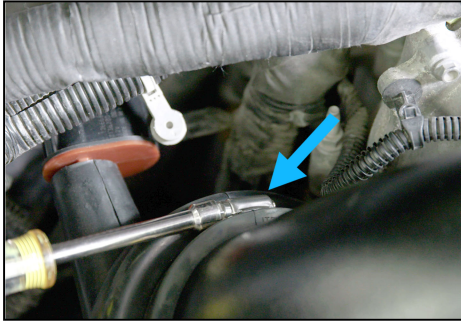

31. Using the 8mm nut driver tighten hose clamp on air INLET/DUCT near turbo inlet to 53 lbf-in (6nm).



32. Replace engine cover onto provided brackets and tighten two bolts using the 8mm socket.



33. Reconnect negative battery cable using the 10mm socket.



34. Slowly lower your hood and check for clearance.

35. Time for a test drive.

*****IMPORTANT*****

Warranty Registration Instructions

***This product comes with a Limited Lifetime Warranty against material defects and product craftsmanship. The intake kit must be registered online for your warranty to be activated. To register your product go to:

www.coldairinductions.com/contact-us/register

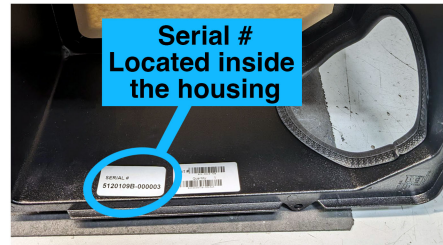

NOTE: NOT LEGAL FOR SALE OR USE IN STATE OF CALIFORNIA



Cold Air Inductions Inc. 717 Burnell Rd. Memphis, MI 48041
Phone: 810-392-9999 Monday-Friday 8:00 am to 4:30 pm EST
Web: coldairinductions.com Email: support@coldairinductions.com